

SITE PLAN

Architectural Working
Drawing Series

Mariya Aminu Kabir
Quif Studio
www.quifstudio.com

Checklist for Site Plan Information

1. The overall dimension of each side of the site.
2. The beacon number of each corner of the site. (a beacon number is placed on all the points of a piece of land indicating its boundaries usually provided by local planning authorities)
3. Bearings of the sides of the site.
4. Contour lines showing the topography of the site.
5. Direction of North.
6. Name of access and adjacent roads.
7. The size and swing of all gates including pedestrian.
8. Levels of drains and discharge point of all drains.
9. The overall dimension (on all sides) of all buildings located on site.
10. The setback on all sides or to adjacent building(s).
11. The location of entrances on each building.
12. The name of the building(s).
13. The finished ground floor level of buildings relative to an agreed datum.
14. The finished levels of all pavements, driveways etc.
15. The finishes of all pavements, driveways etc.
16. The length and width of all pavements, driveways etc.
17. The location and type of landscaping, foundations, sculptures with dimensions and number.

Example of Site Plan

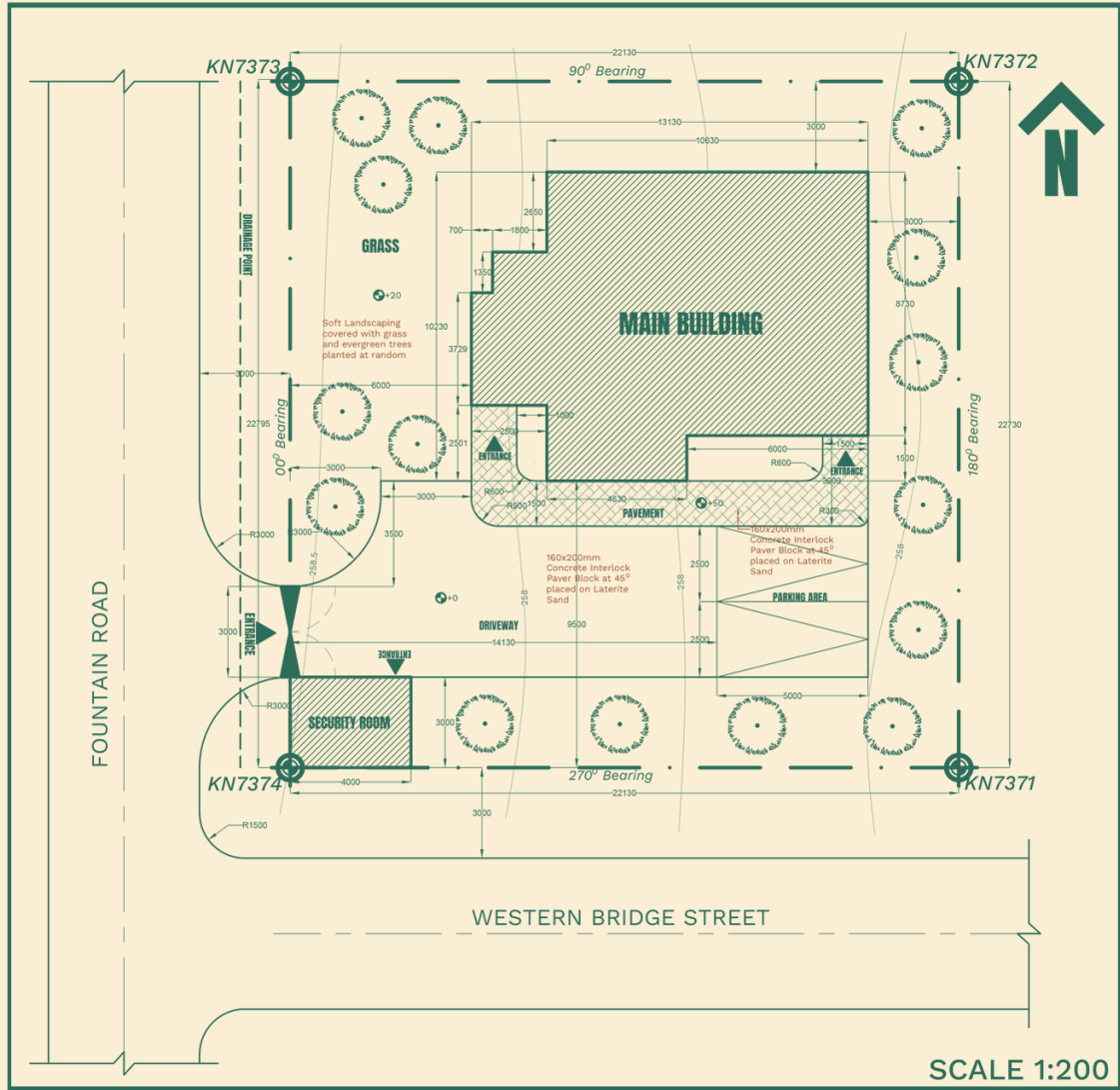

- North Arrow



- Beacon Mark

KN7374 - Beacon Number



- Indicating Entrance



- Levels



- Building/Structure

- Pavement



- Contour Lines



- Property Lines



- Parking Area



- Gate